

# ETNA

KAMBUKKA®

## USAGE RECOMMENDATION

- Suitable for hot and cold beverages.
  - Hours hot: graph 1
  - Hours cold: graph 2
- All of our Kambukka bottles have been rigorously tested at full volume and under a constant temperature.
- Careful: the beverage you are about to enjoy can be hot.
- Keep out of reach of children when filled with hot liquids.
- **1** Do not overfill. Fill liquid maximum up to the shoulder.
- **2** If you fill the bottle with boiling liquids, allow liquid to cool down for at least 3 minutes before sealing with the lid. Extremely hot liquid can build up internal pressure resulting in ejection of liquid and scalding. Always press button with mug in upright position away from face to release pressure before drinking.
- **3** Prior to drinking, check to ensure the lid is properly threaded to the body and screwed down completely.
- Avoid accidental pressing of your drinking button by putting it in locked position when carrying around or putting in a bag.
- **4** Do not microwave and do not freeze.
- Universal lid. Fits any Kambukka body. All of our Kambukka lids are interchangeable however for optimal use we recommend you match the lids to the original bodies.

## CLEANING INSTRUCTIONS

- Wash all parts with soapy water before first use.
- Lids are dishwasher safe.
- If you have purchased a mug that has a brushed stainless steel body (not coloured or painted), the body is dishwasher safe.
- If you have purchased a mug that has a coloured or painted body, it is recommended that the body will be hand washed.
- **5** Pinch to remove the SNAPCLEAN® mechanism for easy cleaning.
- **6** After cleaning, place the mechanism back in the lid. Press the protruding parts down with your thumbs until you hear a click.
- Always store with lid removed.
- Replacement lids are available on our website.

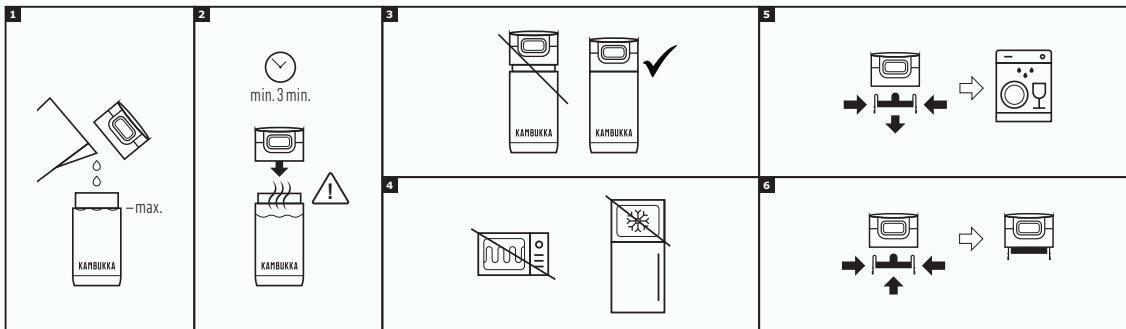

### 3 IN 1 LID

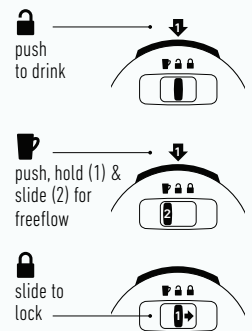

GRAPH 1: HOURS HOT

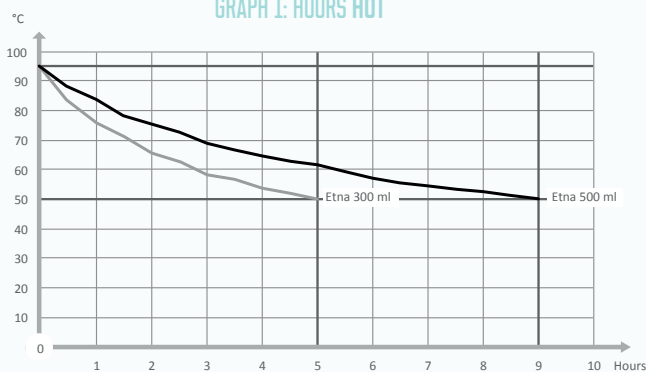

GRAPH 2: HOURS COLD

